

Rate & Totalizing Display

Pulse Input



measuring
•
monitoring
•
analyzing

ZOE



2" Pipe Mounting Kit



- Battery Operated or External DC Power Supply
- LCD-Display, Background Lighting
- Pulse Input (NPN, PNP, NAMUR, or Reed Switch)
- Scalable Pulse Output
- Sensor Supply
- Fully Scalable
- Housings for Wall or Pipe Mounting



Order from: **C A Briggs Company**

622 Mary Street; Suite 101; Warminster, PA 18974

Phone: 267-673-8117 - Fax: 267-673-8118

Sales@cabriggs.com - www.cabriggs.com

KOBOLD Instruments, Inc.
1801 Parkway View Drive
Pittsburgh, PA 15205

Description

The ZOE is specifically designed for the calculation and display of volumetric or mass flow rate & total. It operates via battery or an external power supply. The ZOE can be paired with flowmeters that have a pulse/frequency output. The electronic displays the flow rate, a resettable total, and a grand totalizer. Mass units can also be set. The ZOE is weather resistant and offers IP66/67 protection. The electronics are housed in a UV-resistant, glass-fibre reinforced plastic housing with stainless steel screws and FKM seals. The ZOE is suitable for harsh indoor or outdoor environments and complies with EU Directive 2004/108/EC for electromagnetic compatibility.

Special Features

- Scalable, Resettable, Flow Rate & Totalizer
- Plastic Housing
- Universal Pulse Input
- Linearization Function
- Battery Powered with 3.6 V AA Lithium or 2x AA Standard Alkaline Batteries
- Optional Wall or Pipe Mounting

Additionally for ZOE-ZE:

- External Supply 9-28 V_{DC}
- Scalable Pulse Output
- Sensor Supply
- Background Lighting for the Display

Technical Details

External Supply:	9-28 V _{DC} Power Consumption Max. 40 mA (only ZOE-ZE)
Battery for Operation:	1x 3.6 V AA Lithium Batteries or 2x 1.5V AA Alkaline Batteries
Battery Life:	Using 3.6 V Lithium with 2200 mAh: up to 5 Years (at 50 µA); Using 2x Alkaline Batteries with 2600 mAh each: up to 2 Years (at 50 µA)
Display:	LCD Display (for ZOE-ZE), White Background Lighting) Height of Digits for 5-Digit Volume Flow: 0.51" (13 mm), 8-Digit Volume Totalizer: 0.31" (8 mm), Display of Battery Power
Mounting Options:	Meter Mount, Wall or Pipe Mounting
Measuring Input*:	Universal, Configurable (NPN, PNP, NAMUR Coil, Reed Switch or Active) Input Frequency: 0.1 ... 1000 Hz, High-Low-Threshold 1 V _{DC}



Measured Rate:	1 s
Volume Flow Units:	GPM, GPH, ml/m, l/m, l/h, m³/h, or User-defined
Units for Volume Totalizer:	Gal, ml, l, m³, or User-defined
Control Input (only ZOE-ZE..3):	for Resettable Totalizer
Linearization:	1 ... 9 Interpolation Points, can be Deactivated
Accuracy of Volume Flow Measurement:	< 0.1% of Reading (Depending on Scaling and Resolution)
Sensor Supply (only ZOE-ZE..3):	8 V _{DC} , Max. 25 mA (for External Supply > 10 V _{DC})
Pulse Output (only ZOE-ZE..3):	NPN, Open Collector, Max. 30 V _{DC} , Max. 50 mA
Operation:	4 Buttons
Housing:	Plastic, PA6, GF-reinforced
Protection:	IP 66/67
Cable Entry:	3x M20 x 1.5 or ½" NPT (Prepared)
Electrical Connection:	Plug-in Terminals Wire Size Max. 0.75 mm²
Retention of Meter Readings in Case of Power Failure:	Cyclic, Non-volatile Memory
Ambient Temp:	-4°F ≤ T _{ambient} ≤ 176°F
Storage Temp:	-13°F ≤ T _{storage} ≤ 176°F (without Battery)

*For battery operation: passive reed switches can be used as sensor. Usage of induction coils with high sensitivity (amplitude < 30mV pp) can result in an increase of the minimal range value. Other sensors requiring sensor supply for operation cannot be used for battery operation.

Configurable Display Layouts

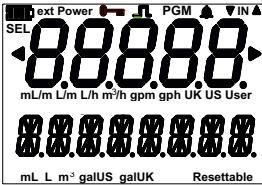
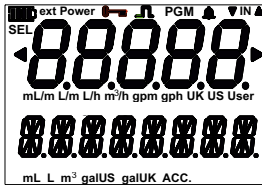
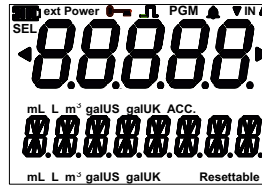
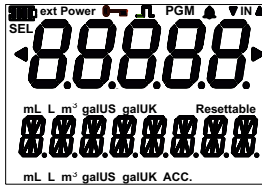
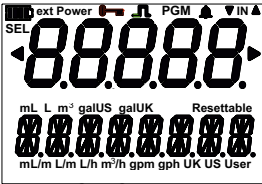
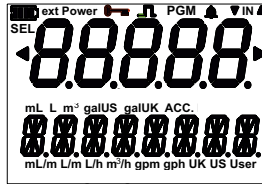
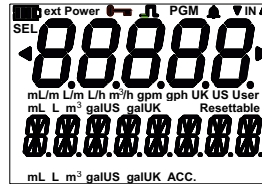
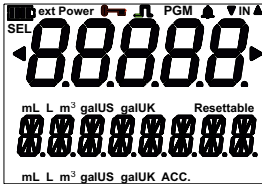
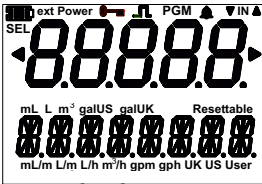
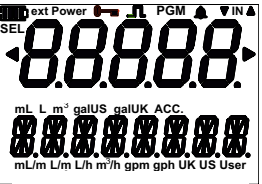
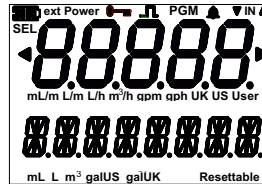
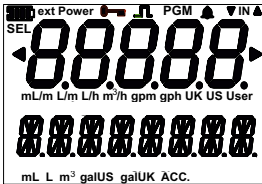
Rate/Resettable Total 	Rate/Grand Total 	Grand Total/Resettable Total 	Resettable Total/Grand Total 
Resettable Total/Rate 	Grand Total/Rate 	Alt/Grand Total  <p>For this layout, the bigger display will alternate b/w partial totalizer and flow, while the smaller display is fixed and will show accumulated totalizer.</p>	Resettable Total/Alt  <p>For this layout, the smaller display will alternate b/w accumulated total and flow, while the bigger display is fixed and will show partial totalizer.</p>
Alt/Rate 	Rate/Alt  <p>For this layout, the bigger display will alternate b/w partial and accumulated total, while the smaller display is fixed.</p>	Rate/Alt 	Rate/Alt  <p>For this layout, the smaller display will alternate b/w partial and accumulated total, while the bigger display is fixed.</p>

Configuration	5-Digit Larger Display	8-Digit Smaller Display
Rate/Resettable Total	Rate Display	Resettable Total Display
Grand Total/Resettable Total	Grand Total Display	Resettable Total Display
Resettable Total/Rate	Resettable Total Display	Rate Display
Alternating/Grand Total	Alternating Display between Rate Display and Resettable Total Display	Grand Total Display
Alternating/Rate	Alternating Display between Grand Total and Resettable Total	Rate Display
Rate/Grand Total	Rate Display	Grand Total Display
Resettable Total/Grand Total	Resettable Total Display	Grand Total Display
Grand Total/Rate	Grand Total Display	Rate Display
Resettable Total/Alternating	Resettable Total Display	Alternating between Grand Total Display and Rate Display
Rate/Alternating	Rate Display	Alternating between Grand Total Display and Resettable Total Display



Rate & Totalizing Display Model ZOE

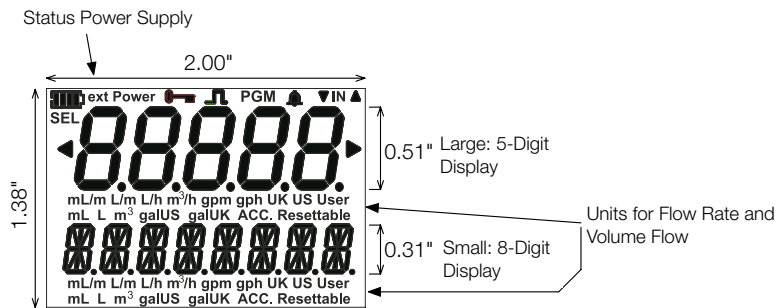

Order Details (Example: ZOE-ZE K MF 30 0)

Model	Electronics	Housing Type	Electrical Connection/ Cable Gland	Power Supply	Options
ZOE-	..ZB.. = Rate Totalizer Battery Powered	..0.. = Universal Mount (Standard, Round Plastic without Mounting Plates, without Holes)	..MF.. = 3x M20 x1.5 Cable Entry	..B0 ¹⁾ .. = Battery for Operation	..0 = No Options
	..ZE.. = Rate Totalizer Battery Powered & Externally Powered	..K.. = Universal Mount (Standard, Round Plastic with Mounting Plates) ..M.. = Universal Mount (Round Plastic for Retrofitting DON)	..NF.. = 3x ½" NPT Cable Entry	..30 ²⁾ .. = 9-28 V _{DC} , Battery for Operation, Pulse Output	

¹⁾ Only available with ZOE-ZB

²⁾ Pulse output, sensor supply, and LCD backlight only with external power supply ZOE-ZE

Dimensions

ZOE-..K

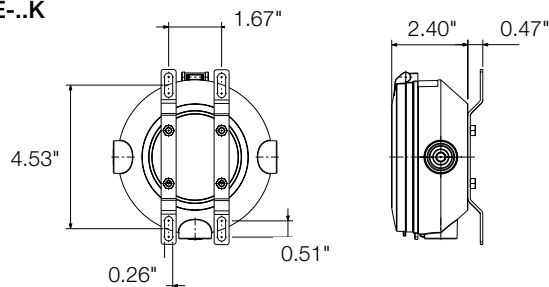

ZOE-..M, ZOE-..0

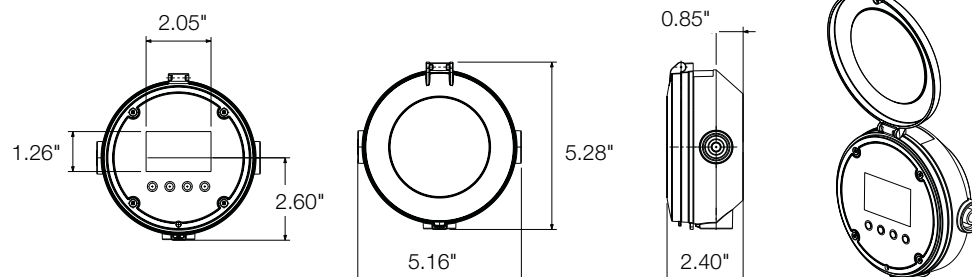

Accessories

Description	Model
Stainless Steel Wall Mounting Kit	ERS-ZOK-023618
Stainless Steel 2" Pipe Mounting Kit	ERS-ZOK-003402