



## Features

- 4-20 mA, 2-Wire Analog Output
- 4" Nominal Dial Face
- Stainless Steel Construction
- $\pm 0.5\%$  Accuracy
- Pulsation and Vibration Damping Via Optional Oil Filling

Are you looking for traditional mechanical pressure indication, but need a 4-20 mA output? The KOBOLD DZF26 is the gauge you're looking for. We construct the DZF26 from corrosion resistant stainless steel to allow installation into the widest variety of process applications. The fast reacting pointer indicator may be oil damped to allow easy reading with surging or pulsating media.

## Specifications

**Ranges:** 0-5,000 PSIG  
(see table)

**Over Pressure Protection**  
**Momentary:** 1.15 to 1.3 x  
range max.

**Sensing Element:** Bourdon Tube w/  
Hall Sensor

### Accuracy

**No Oil Filling**  $\pm 0.5\%$  of full scale  
**With Oil Filling:**  $\pm 1.0\%$  of full scale

### Operating Temperature

**Medium:** 15 to 150°F  
**Ambient:** 15 to 140°F

**Fittings:**  $\frac{1}{2}$ " NPT

### Materials of Construction

#### Wetted Parts

**Element:** Ceramic  
**Seals:** PTFE  
**Fitting:** 304 SS

## Dimensions (mm)

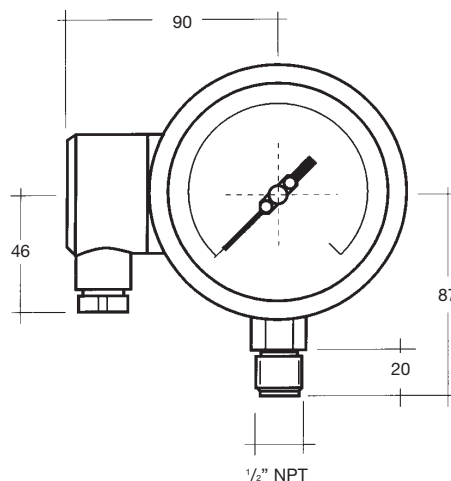

## KOBOLD DZF26 Pressure Gauge

### Exterior

**Housing:** 304 SS  
**Bezel:** 304 SS  
**Pointer:** Black aluminum  
**Indicator Dial:** White aluminum  
**Window:** Safety glass

### Electrical

**Output:** 4-20 mA, 2-wire  
**Supply Voltage:** 10-32 VDC  
**Temperature Coefficients**  
**Compensation:** 15 to 100°F

### Drift:

<0.05% per °F  
in comp. range  
**Connector:** Hirschmann style  
DIN 43650 Plug

### Environmental Protection

**Unfilled Housings:** NEMA 4  
**Paraffin Oil Filled:** NEMA 4

### Options:

Oil damped  
indicator assembly

## DZF26 Ordering Information

**DZF26** = Stainless Steel Pressure Gauge with Analog Output

### -Range

= Pressure Range Abbreviation

### Available Measuring Ranges

<b>115</b> = 15 PSIG	<b>210</b> = 100 PSIG	<b>230</b> = 300 PSIG	<b>320</b> = 2000 PSIG
<b>130</b> = 30 PSIG	<b>216</b> = 160 PSIG	<b>260</b> = 600 PSIG	<b>330</b> = 3000 PSIG
<b>160</b> = 60 PSIG	<b>220</b> = 200 PSIG	<b>310</b> = 1000 PSIG	<b>350</b> = 5000 PSIG

**F** = Paraffin oil damped indicator assembly

### Options

**DZF26**

**220**

**F**

**Sample DZF26 Specification**

Order from: **C A Briggs Company**

622 Mary Street; Suite 101; Warminster, PA 18974

Phone: 267-673-8117 - Fax: 267-673-8118

[Sales@cabriggs.com](mailto:Sales@cabriggs.com) - [www.cabriggs.com](http://www.cabriggs.com)

Subject to change without prior notice.